

SilkBio-101TC

Multi-Bio Time Attendance & Access Control Terminal



SilkBio-101TC is Time & Attendance and Access Control Terminal to be associated with Z-ID fingerprint reader, face recognition and RFID card functions. With the new Z-ID fingerprint reader, the operation remains stable under strong light source and high preciseness of verification of wet and rough fingers. With latest facial algorithm and the innovation features, SilkBio-101TC is bringing you the whole new experience.

Features

- Multi-biometric fast verification
- Touch Keypad
- Infrared auto-turning on function to save power
- Quick recognition of dry, wet and rough fingers
- Multi-language supported
- Built-in 2000mAh backup battery to extend operation time
- Prevents duplicated face registration and supports fake face detection function

Specifications

Face Capacity	2,000
Fingerprint Capacity	3,000
Card Capacity	3,000 (Optional)
Algorithm	ZKFinger V10.0 / ZKFace V5.8
Record Capacity	100,000
Display	2.8-inch TFT Screen
Communication	TCP/IP, USB-Host, Wi-Fi (Optional)
Standard Functions	Work Code, SMS, DST, Scheduled-bell, Self-Service Query, Automatic Status Switch, Photo ID T9 Input, Camera, 9 digit user ID, Built-in Battery, Multiple Verify Mode
Access Control Interface for	Lock, Door Sensor, Exit Button, Alarm
Optional Functions	ID / IC, ADMS, External Printer and Bell
Power Supply	DC 12V 1.5A
Operating Temp.	0 °C- 45 °C
Operating Humidity	20%-80%
Dimension	180 x 154 x 34.2 mm

Configuration

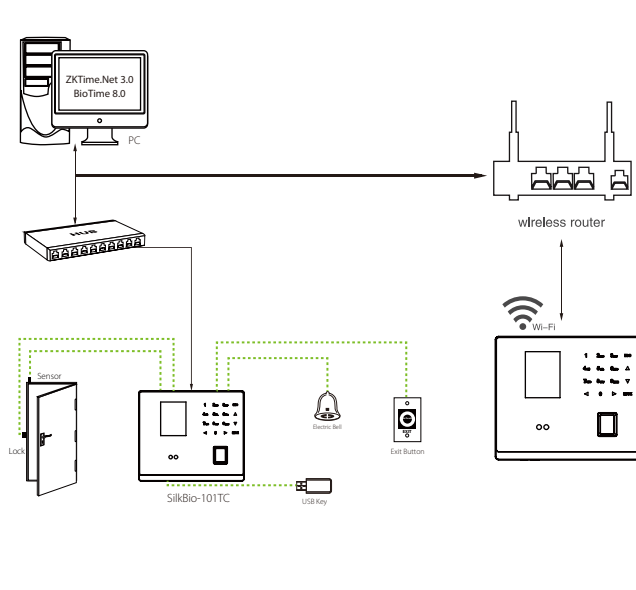

Dimensions

